

- CON EDISON PROPERTY
- HOLTEC PROPERTY
- DELINEATED WETLAND
- PROPOSED ATHLETIC FIELDS
- PROPOSED CORTLANDT PITCH BUILDING
- PROPOSED ROADWAYS AND PARKING LOTS
- PROPOSED STORMWATER MANAGEMENT AREA
- POTENTIAL PRIVATE DEVELOPMENT SITE



DRAFT

IT IS A VIOLATION OF THE NEW YORK STATE EDUCATION LAW, ARTICLE 145 §7209 SPECIAL PROVISIONS, FOR ANY PERSON, UNLESS THEY ARE ACTING UNDER THE DIRECTION OF A LICENSED PROFESSIONAL ENGINEER, ARCHITECT, LANDSCAPE ARCHITECT, OR LAND SURVEYOR, TO ALTER AN ITEM IN ANY WAY. IF AN ITEM BEARING THE STAMP OF A LICENSED PROFESSIONAL IS ALTERED, THE ALTERING PROFESSIONAL SHALL STAMP THE DOCUMENT AND INCLUDE THE NOTATION "ALTERED BY" FOLLOWED BY THEIR SIGNATURE, THE DATE OF SUCH ALTERATION, AND A SPECIFIC DESCRIPTION OF THE ALTERATION.

REVISIONS	

TOWN OF CORTLANDT
CORTLANDT QUARRY PARK INFRASTRUCTURE DEVELOPMENT PROJECT

ENLARGED SITE PLAN

WESTCHESTER COUNTY, NEW YORK

TOWN OF CORTLANDT

B&L
Pinewood Business Center
247 Route 100
Suite 2000D
Somers, NY
10589
Barton & Loguidice, D.P.C.

PRELIMINARY
10/10/2023

Date
OCTOBER 2023

Scale
1" = 80'

Sheet Number
C100

Project Number
2520.001.001

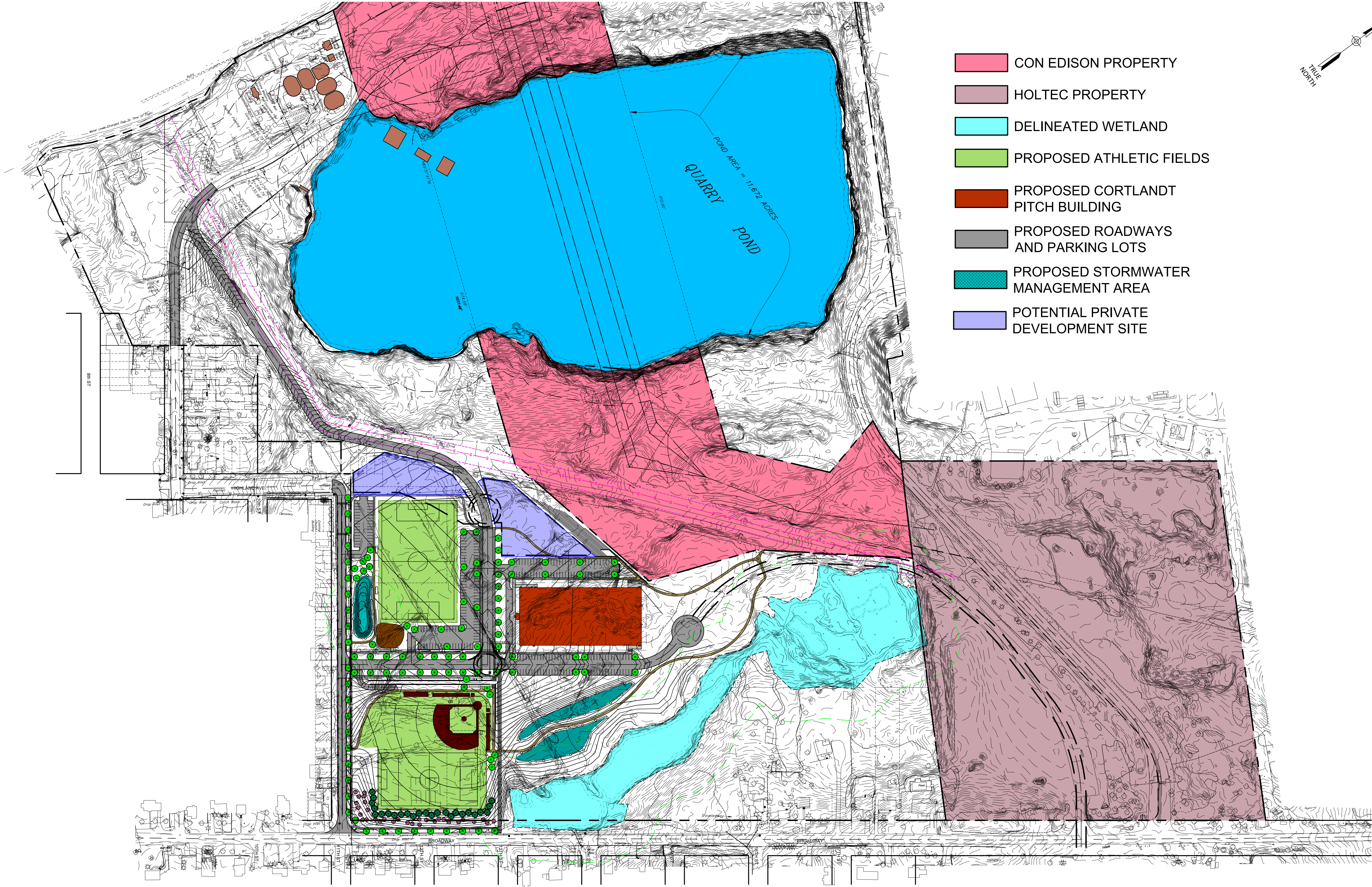

- CON EDISON PROPERTY
- HOLTEC PROPERTY
- DELINEATED WETLAND
- PROPOSED ATHLETIC FIELDS
- PROPOSED CORTLANDT PITCH BUILDING
- PROPOSED ROADWAYS AND PARKING LOTS
- PROPOSED STORMWATER MANAGEMENT AREA
- POTENTIAL PRIVATE DEVELOPMENT SITE

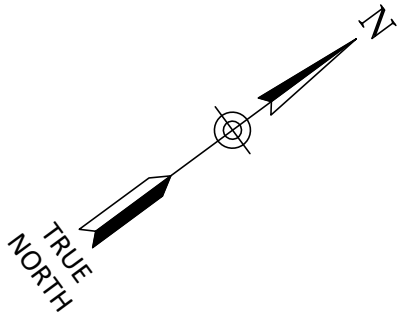

150' 0 150' 300'
1"=150'

DRAFT

IT IS A VIOLATION OF THE NEW YORK STATE EDUCATION LAW, ARTICLE 145 §7209 SPECIAL PROVISIONS, FOR ANY PERSON, UNLESS THEY ARE ACTING UNDER THE DIRECTION OF A LICENSED PROFESSIONAL ENGINEER, ARCHITECT, LANDSCAPE ARCHITECT, OR LAND SURVEYOR, TO ALTER AN ITEM IN ANY WAY. IF AN ITEM BEARING THE STAMP OF A LICENSED PROFESSIONAL IS ALTERED, THE ALTERING PROFESSIONAL SHALL STAMP THE DOCUMENT AND INCLUDE THE NOTATION "ALTERED BY" FOLLOWED BY THEIR SIGNATURE, THE DATE OF SUCH ALTERATION, AND A SPECIFIC DESCRIPTION OF THE ALTERATION.

REVISIONS	

TOWN OF CORTLANDT
CORTLANDT QUARRY PARK INFRASTRUCTURE DEVELOPMENT PROJECT

OVERALL SITE PLAN

WESTCHESTER COUNTY, NEW YORK

TOWN OF CORTLANDT

Pinewood Business Center
247 Route 100
Suite 2000D
Somers, NY
10589

B&L

Barton & Loguidice, D.P.C.

PRELIMINARY
10/10/2023

Date
OCTOBER 2023

Scale
1" = 150'

Sheet Number
C101

Project Number
2520.001.001